

**Weidmüller – Partner in Industrial Connectivity.**

As experienced experts we support our customers and partners around the world with products, solutions and services in the industrial environment of power, signal and data. We are at home in their industries and markets and know the technological challenges of tomorrow. We are therefore continuously developing innovative, sustainable and useful solutions for their individual needs. Together we set standards in Industrial Connectivity.

**You transmit signals in as small a space as possible  
We efficiently marshal and distribute them for you  
Let's connect.**

## Efficient marshalling and distribution of signals in the process industry

Save money and space using the PRV/PPV and WMF terminal blocks

Space for wiring is scarce and expensive – so as many signals as possible must be transmitted, secured and separated in as small a space as possible. This saves valuable space, installation time and helps create order. These requirements are met by Weidmüller's new PRV/PPV and WMF marshalling terminal blocks.

Measurement and control signals from the field devices are connected to the control systems using a field distributor and master cable to the controller. This is an inexpensive way to reduce the number of cables in the field and to simplify the installation. Marshalling cabinets are used in which the signals are collected from the field, sorted and grouped before being connected to the control unit. This sort of wiring is future-proof – if a subsequent change is made to the instrumentation or the control unit is replaced, you do not need to replace the wiring out to the field. Only the wiring in the marshalling cabinet needs normally to be changed.

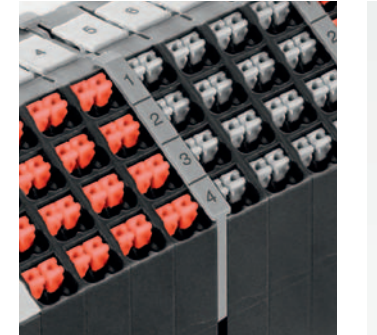

### Optimal orientation

You have a clear view during add-on or maintenance work: the coloured operational elements allow you to logically arrange the PRV terminal blocks so that the signals can be assigned without error.

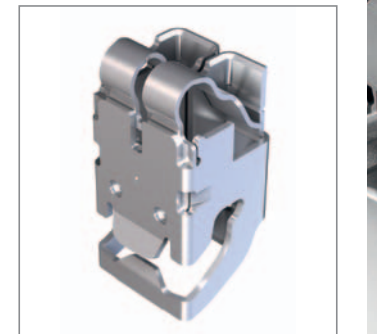

### Secure connectivity

Secure contacts and simple operation: with advanced PUSH IN tension clamp connections

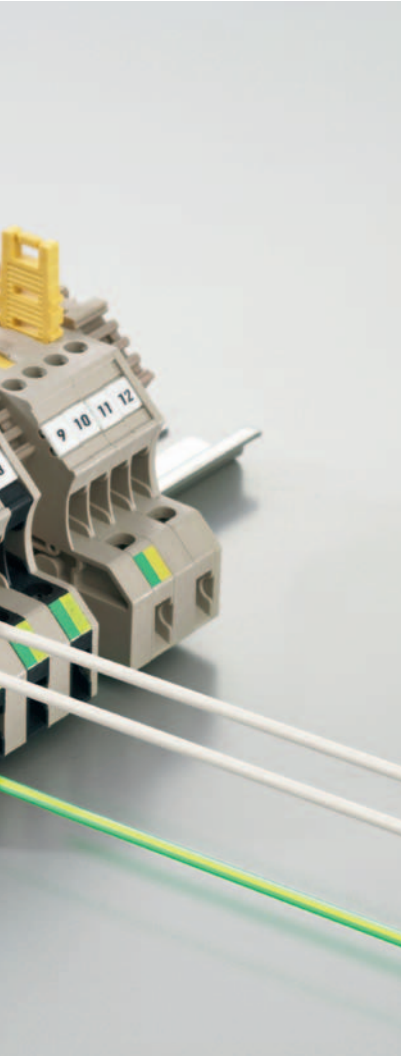

### Fuse is convenient to replace

The new design of the fuse holder includes a pivoting safety latch – this enables the fuse to be replaced quickly and reliably.

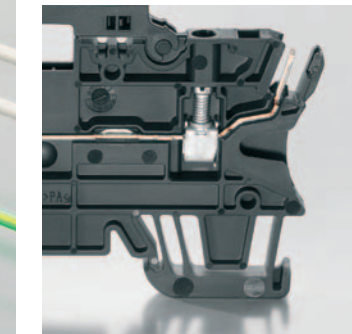

### Global reliability

functionality into a single solution: It features an integrated shield connection and can be used with feed-through, fuse and disconnect functionality. The three cross-connection channels and wide variety of labelling/marketing options provide additional flexibility.

Weidmüller's proven screw-connection mechanism guarantees that the product will be easy to operate, recognize, and maintain anywhere throughout the world.



Weidmüller Interface GmbH & Co. KG  
Klingenbergstraße 16  
32758 Detmold, Germany  
Phone +49 5231 1429-0  
Fax +49 5231 1429-2083  
info@weidmueller.com  
www.weidmueller.com



1364630000/04/2012/SMKW



product design award

2012



**Weidmüller**

## You have the choice

A product range that perfectly fits your application



- Multimeter**  
Digital test tools for reliably determining various measurement values
- RockStar® heavy-duty connectors**  
Durable connections with die-cast aluminium housings and a modular design
- Wire markers**  
Markers suitable for a wide range of conductor diameters
- Klippon® enclosures and cable glands**  
Ready wired enclosures for the installation with customer specific assembly and Ex approval
- ACT20M and ACT20X signal conditioners**  
Isolates and conditions signals: with a 6 mm width, even in Ex areas
- KLBÜ clamping yoke**  
Electromagnetical compatibility via safe and large shield connection
- PRO-H power supply**  
Switch-mode power supplies for process industry and challenging automation engineering applications
- Terminal blocks**  
Always the right connection: with PUSH IN, clamping yoke or tension clamp technology
- Industrial Ethernet wiring solutions**  
Particularly powerful and versatile thanks to the **STEADYTEC®** technology

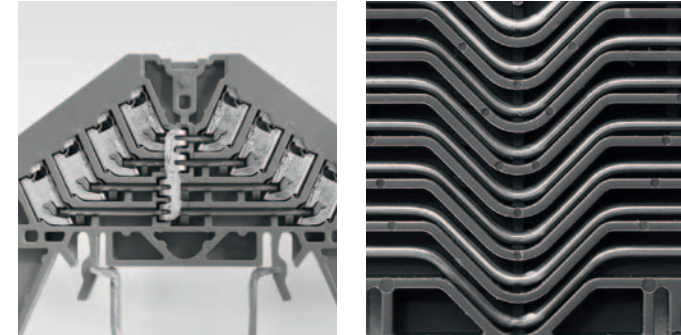

- PPV potential distribution terminal**  
The four-way and eight-way marshalling terminals are also available as potential distribution terminals; they distribute potentials simply and safely.
- Low contact resistances**  
The busbar's unique V-shape compensates for the varying expansion of material and ensures low and constant contact resistances.

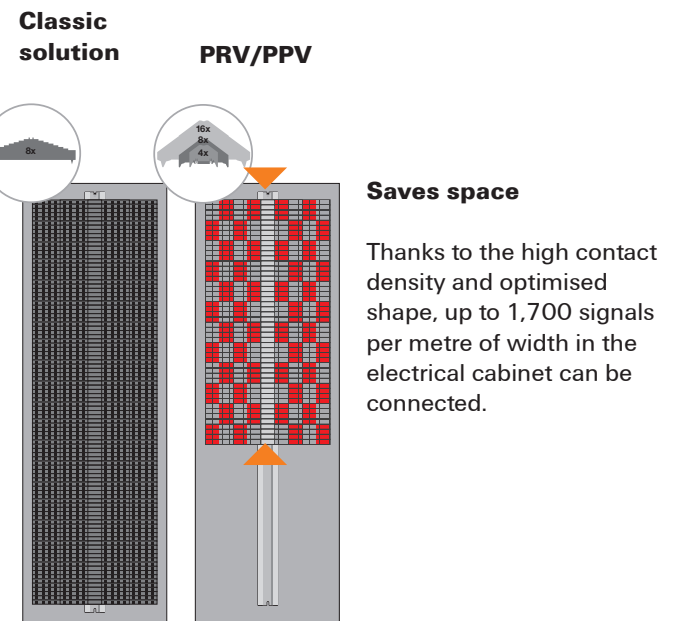

**Saves space**  
Thanks to the high contact density and optimised shape, up to 1,700 signals per metre of width in the electrical cabinet can be connected.

## PRV and PPV

Marshalling and distributing signals with the PUSH IN marshalling and potential distribution terminals

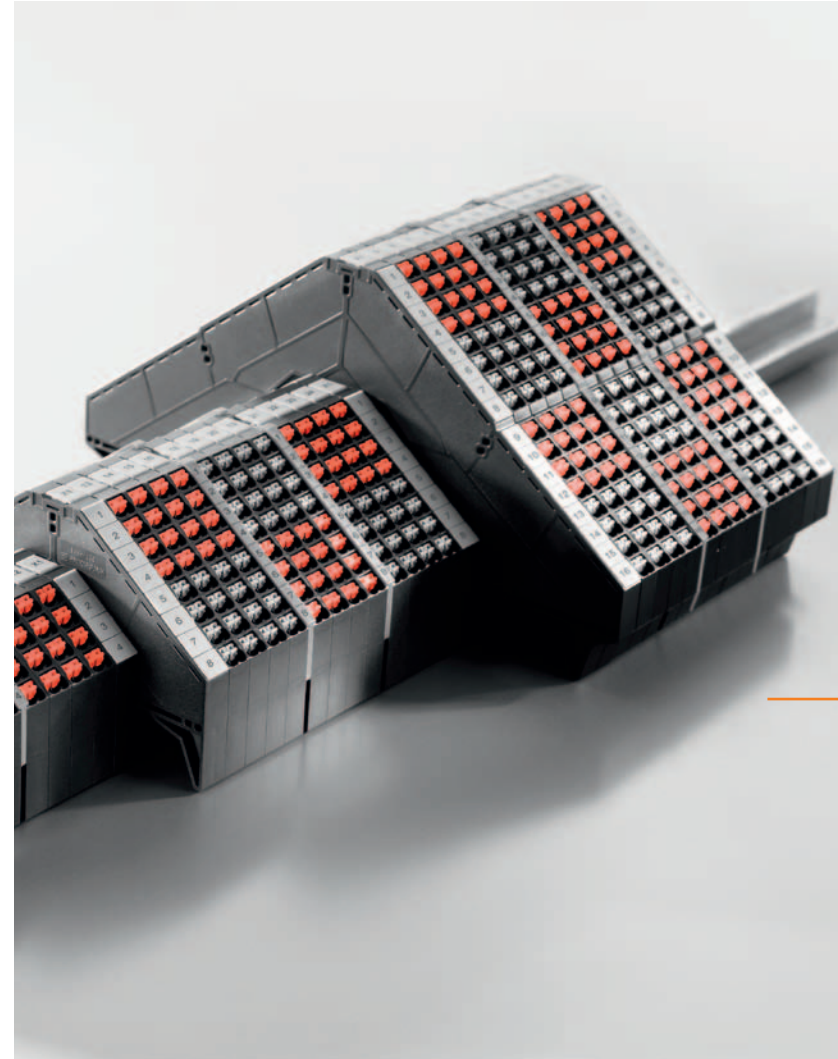

The demands on automation processes are growing more complex, while requirements for monitoring and data recording are also increasing. As a result, the number of measuring instruments used in the field for control systems continues to rise. That is giving planning engineers new challenges to overcome: On the one hand, the additional signals for the automation need to be connected and processed. On the other hand, extra space is associated with increased costs. The new marshalling and potential distribution terminals from Weidmüller are designed to satisfy these requirements.

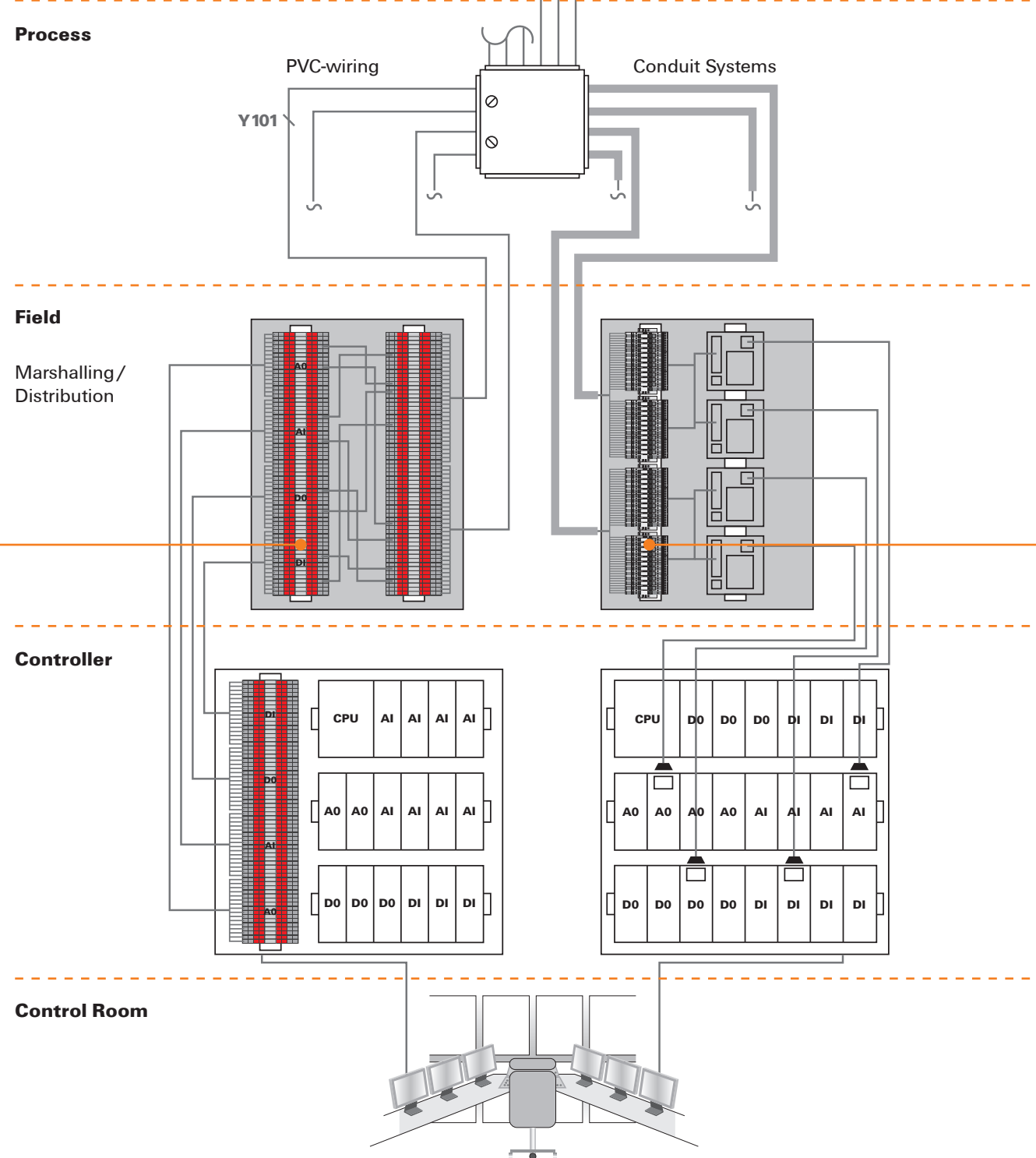
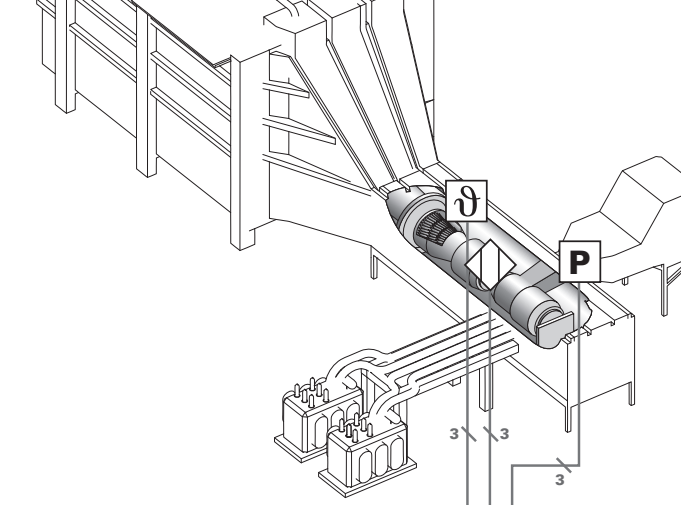

## WMF terminals

The efficient and extremely flexible solution for marshalling signals

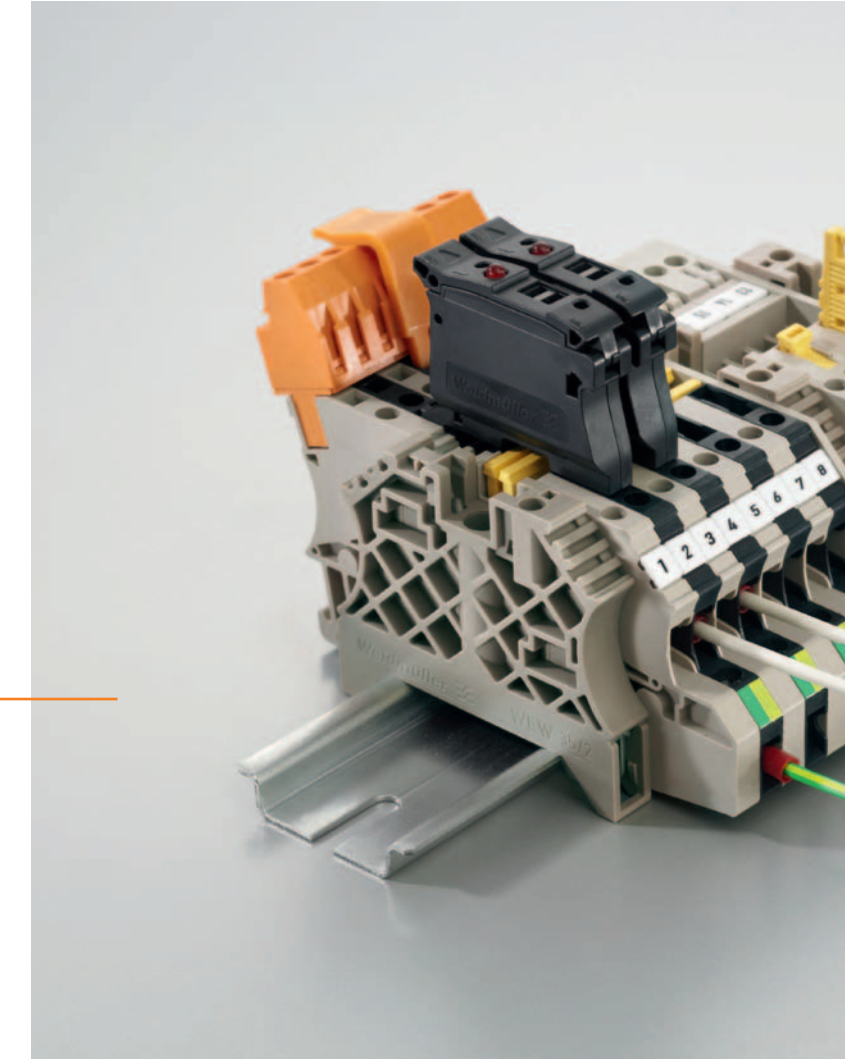

In process control systems for facilities in the process and power generation sectors, incoming signals from field devices are often connected with terminal blocks in marshalling cabinets. Terminal blocks are used despite the existence of alternative technologies such as Remote I/O and Fieldbus.

This is mainly because they offer a sturdy and simple connection system, and because they are clearly arranged. Weidmüller's new WMF (Weidmüller Multi Funktional) line of terminal blocks provide a multi-functional solution for marshalling signals. This space-saving terminal combines all the necessary

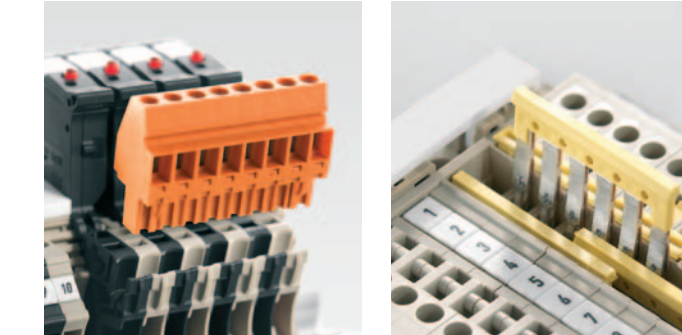

- Plug-and-play marshalling**  
Instead of using a screw connection to contact each signal at the routing levels, pre-assembled cable sets with BLZ mating profiles are used. This saves you valuable wiring time in the field.
- Cross-connection channels**  
The WMF terminal block has three cross-connection channels; they are a very flexible solutions for bundling and looping through of potentials. The standard ZQV cross-connections can be used to join both the neutral wire and also a shielded potential voltage across a large number of poles.

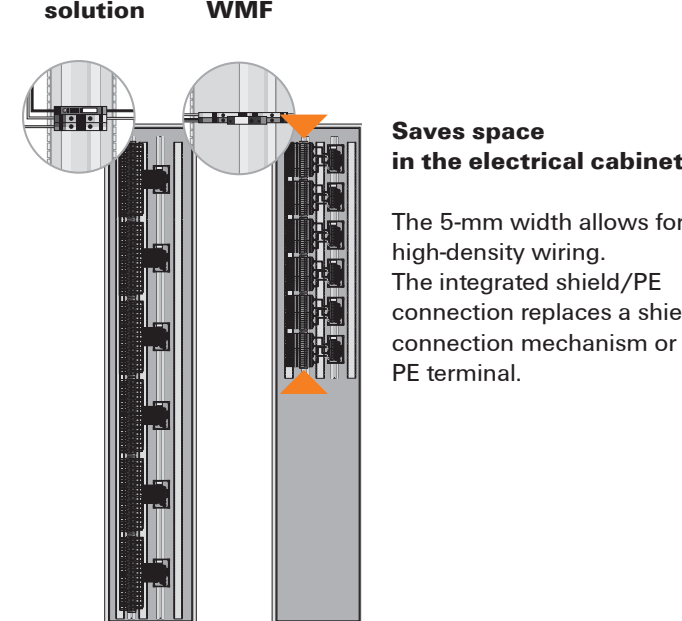

**Saves space in the electrical cabinet**  
The 5-mm width allows for high-density wiring. The integrated shield/PE connection replaces a shield-connection mechanism or PE terminal.

## You have the choice

A product range that perfectly fits your application

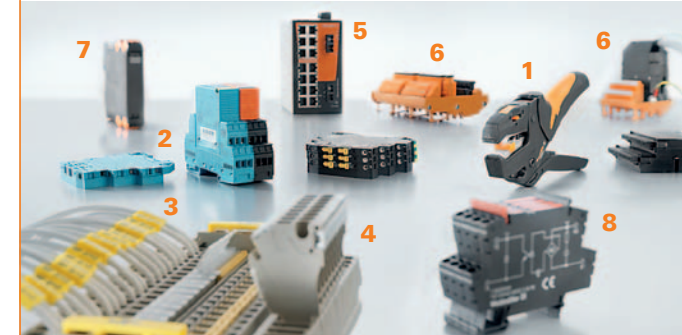

- Tools**  
Professional hand tools and machines for fast and secure processing
- Lightning/surge protection VARITECTOR**  
Protection for instrumentation and control in a terminal block design: including an isolating/measurement function and signalling
- Cable markers**  
Markers suitable for a wide range of cable diameters
- WeiCoS connection system**  
A modular combination of terminal blocks and pluggable connection technology
- Industrial Ethernet**  
Managed and unmanaged switches for interference-free data transmission in demanding networks
- Interface units**  
A smooth transition from standard plug-in connector systems to single-core wiring or other connection systems
- Modular component housing**  
Tailor-made component housings to integrate innovative electronics onto mounting rails
- Relays and Solid-State Relays**  
Electromechanical and electronic coupling modules in a terminal block design